

**GW C300**  
**WATER CONTROL VALVE**  
Non-regulating  
GENERAL SPARES SCHEDULE

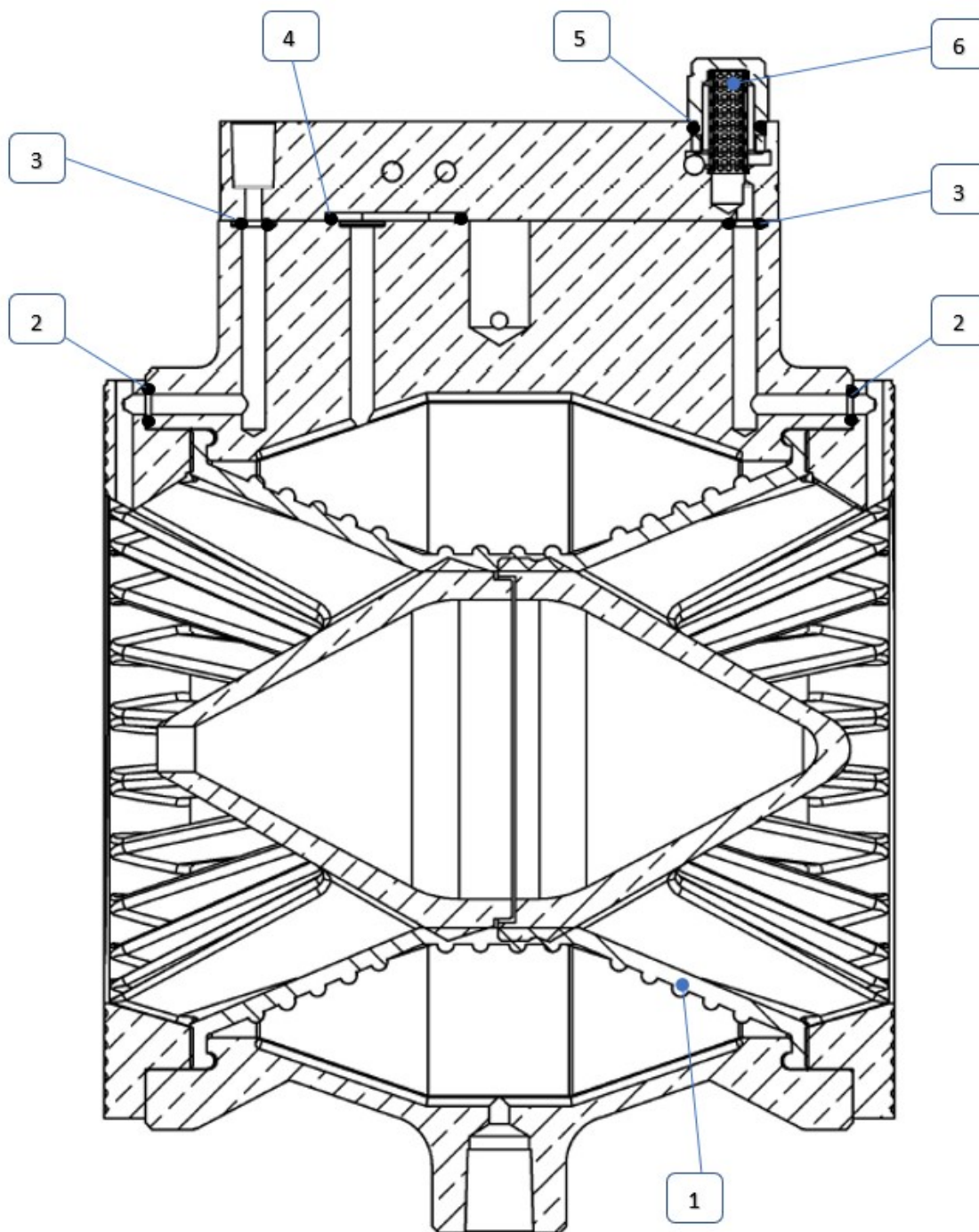

**GW SPRINKLER A/S**



**GW SPRINKLER A/S**

Kastanievej 15, DK-5620 Glamsbjerg, Denmark  
TEL: +45 64 72 20 55 FAX: +45 64 72 22 55  
E-mail: sales.dep@gwsprinkler.com

Data Sheet: General Spares Schedule  
C-300 Non-regulating

Page: 1 of 2  
Issue / Date: 17.09.2020

**DATA SHEET No: DV070 1002 A**

**GW C300**  
**WATER CONTROL VALVE**  
**Non-regulating**  
**GENERAL SPARES SCHEDULE**



**GW SPRINKLER A/S**

Pos. No.	Description	Qty.	Part Number					
			Valve Size:					
			80 (3")	100 (4")	150 (6")	200 (8")	250 (10")	300 (12")
-	<b>Elastomer Flow Control Sleeve c/w O-Ring spares Kit<sup>1</sup></b>	1	<b>CV64/90119N</b>	<b>CV64/90120N</b>	<b>CV64/90121N</b>	<b>CV64/90122N</b>	<b>CV64/90123N</b>	<b>CV64/90124N</b>
1	Sleeve	1	CV64/70159	CV64/70040	CV64/70044	CV64/70058	CV64/70065	CV64/70073
-	Instructions	1	CV64/70347	CV64/70347	CV64/70347	CV64/70347	CV64/70347	CV64/70347
-	<b>O-Ring Kit w. Strainer</b>	1	<b>CV64/90126N*</b>	<b>CV64/90126N*</b>	<b>CV64/90126N*</b>	<b>CV64/90126N*</b>	<b>CV64/90126N*</b>	<b>CV64/90126N*</b>
2	O-Ring	2	N/A	N/A	CV50/71202	CV50/71202	CV40/70012	CV40/70012
3	O-Ring	2	CV50/70089	CV50/70089	CV50/71048	CV50/71048	CV40/70012	CV40/70012
4	O-Ring	1	CV40/70329	CV40/70329	CV40/70329	CV40/70329	CV40/70329	CV40/70329
5	O-Ring	1	CVI74227	CVI74227	CVI74227	CVI74227	CVI74227	CVI74227
6	Strainer (Monel)	1	CV64/70050	CV64/70050	CV64/70050	CV64/70050	CV64/70050	CV64/70050
-	Lubricant (10 g)	1	CV64/70444	CV64/70444	CV64/70444	CV64/70444	CV64/70444	CV64/70444
<b>Required Commissioning / Maintenance Accessories</b>					<b>Part Number</b>		* O-ring kit <b>CV64/90126N</b> contains the full range of O-rings to fit all sizes of valves. (12 O-rings in a kit)	
Rubber Lubricant Emulsion (for smooth insertion of flow sleeve)					CV64/62163			
Restrictor Insertion / Removal Tool					CV64/70505			
Restrictor Adjusting Tool					CV64/70506			

<sup>1</sup> Elastomeric Sleeves, Diaphragms and Seals should be stored in sealed lightproof black bags. Spare stocks of sleeves, diaphragms and seals should be used within a two-year shelf life to provide a three-year in-service life (five-year total life).

**Flow control sleeve – dimension overview**

Valve size (inch)	3	4	6	8	10	12
Valve size (mm)	80	100	150	200	250	300
Sleeve part no.	CV64/70159	CV64/70040	CV64/70044	CV64/70058	CV64/70065	CV64/70073
A (mm)	125	124	188	258	294	380
B (mm)	119	150	192	258	321	376

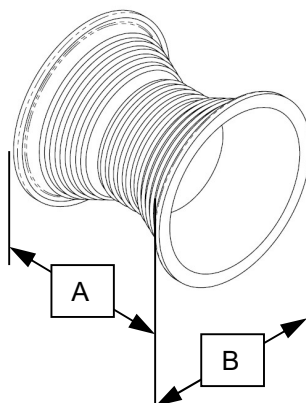

**GW SPRINKLER A/S**

Kastanievej 15, DK-5620 Glamsbjerg, Denmark  
 TEL: +45 64 72 20 55 FAX: +45 64 72 22 55  
 E-mail: sales.dep@gwsprinkler.com

Data Sheet: General Spares Schedule  
 C-300 Non-regulating

Page: 2 of 2  
 Issue / Date: 17.09.2020

**DATA SHEET No: DV070 1002 A**